

LAHTI 2040: NATURE, ETHNICITY AND EASY LIFE

Team 7: WAD

Maryam Khalid, Aleksandra Sokolova, Olga Shilovskaia,
Teemu Vesa, Terhi Raikas, Chinmay Deshmukh



YOU DO NOT NEED TO GO TO A SUMMER COTTAGE WHEN YOU LIVE IN LAHTI

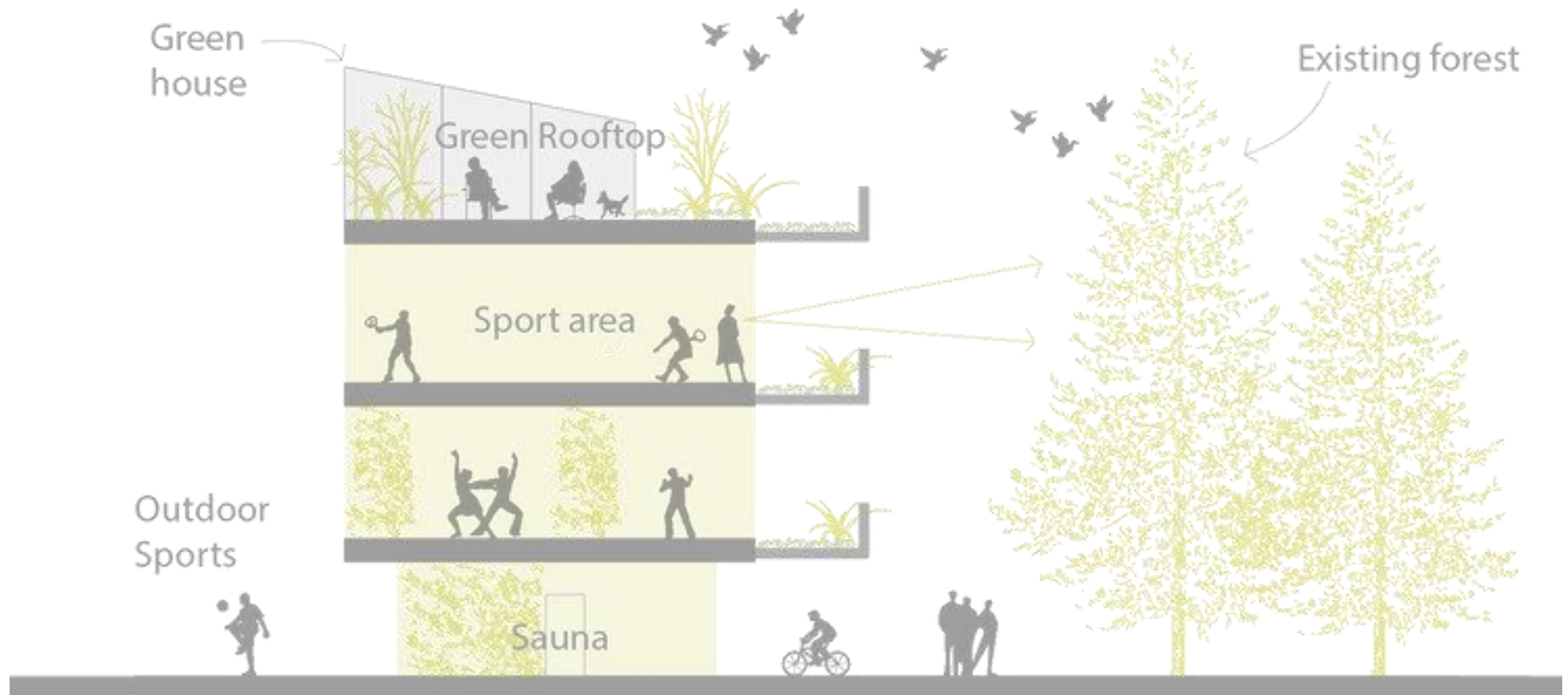

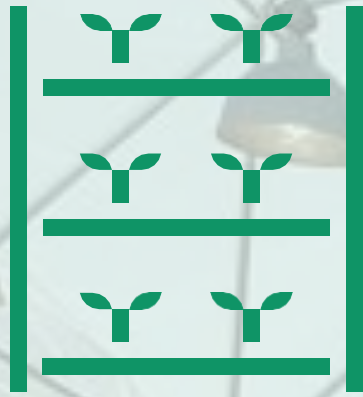

VERTICAL
FARMING



STORM WATER
MANAGEMENT



HOBBY AND MENTAL
PEACE



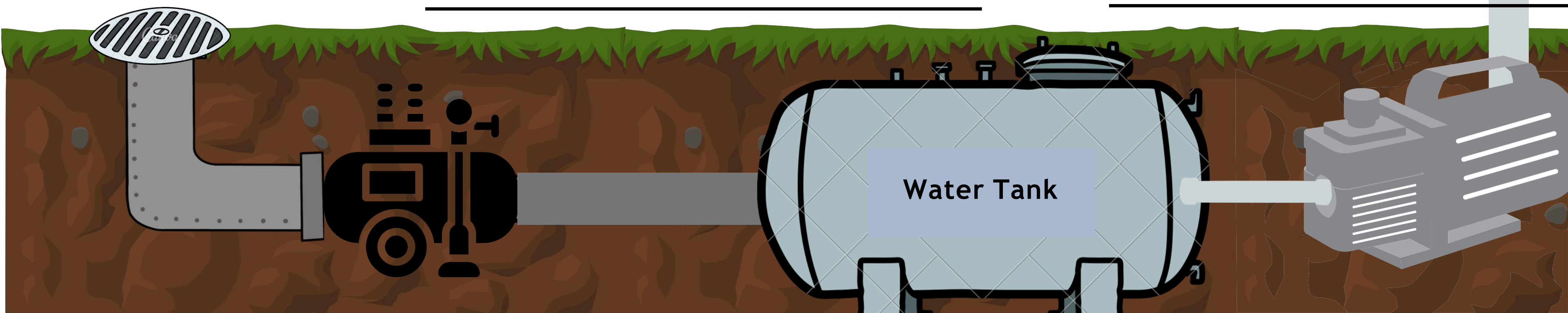
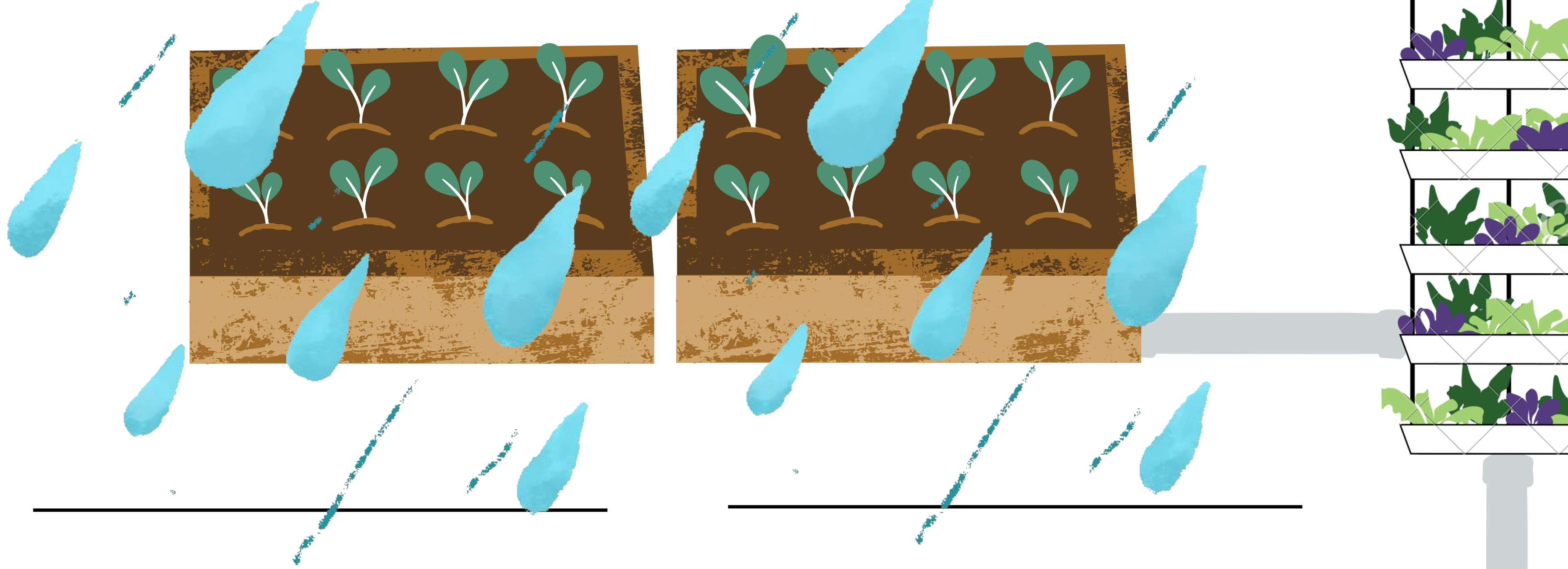

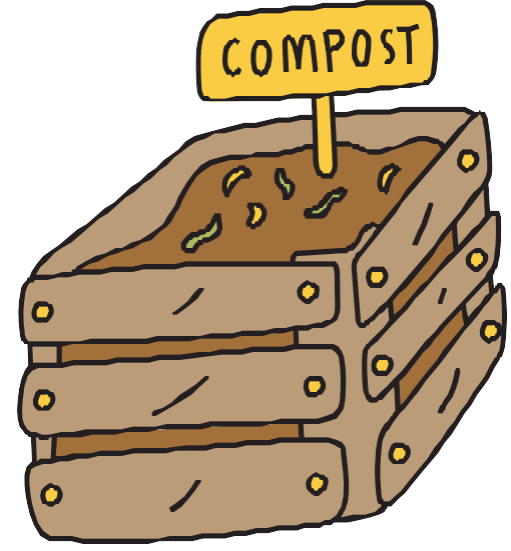

biowaste

restaurants

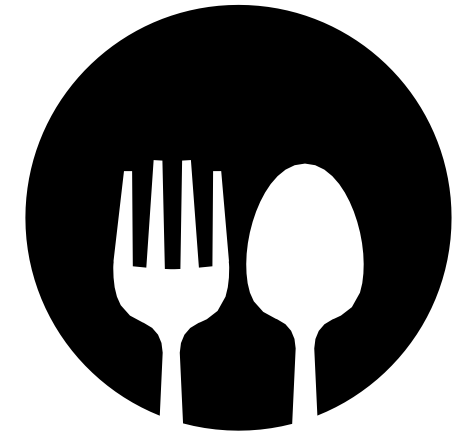

atmosphere

Vertical farm



s
nutrient

nutrient

n
Carbo

Carbo

Excess heat

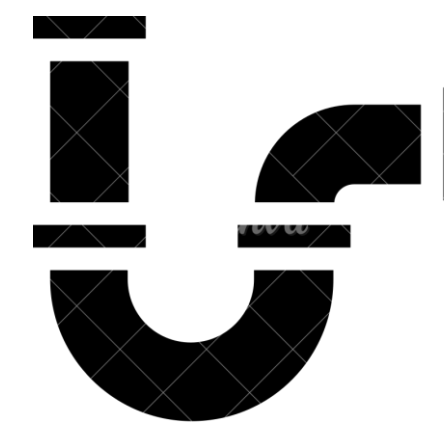
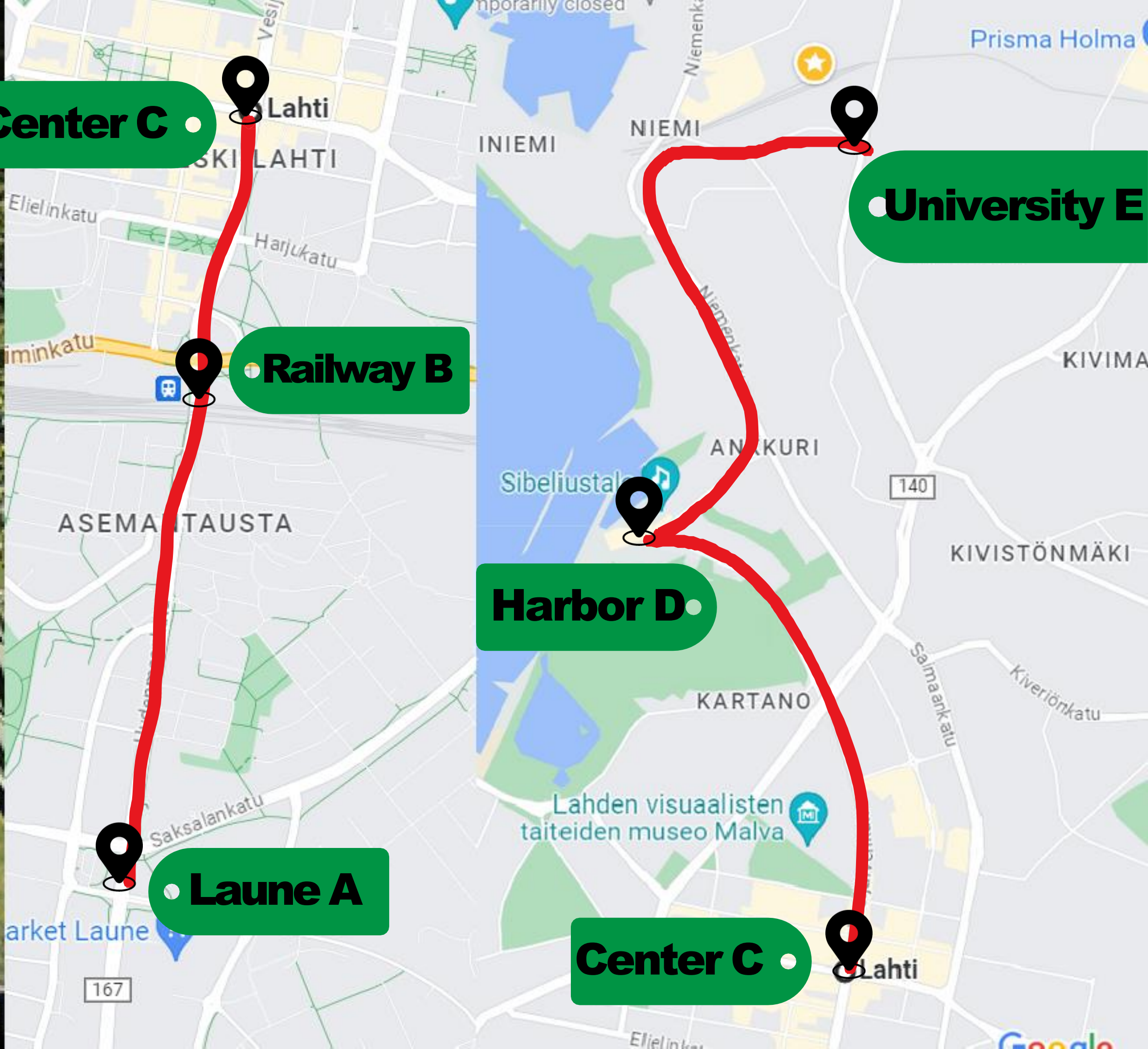

Image: ifarm



outdoor farm

Image: the spruce





EFFICIENT *and*
CONVENIENT





Small Businesses



Tourism



Connectivity



**Railway track cafe
proposal**

Converting railway track into
cafe for people to socialise.



Hollola, Vääksy,
Heinola & Jyväskylä



Decarbonized and
sustainable future



Beautiful voyage



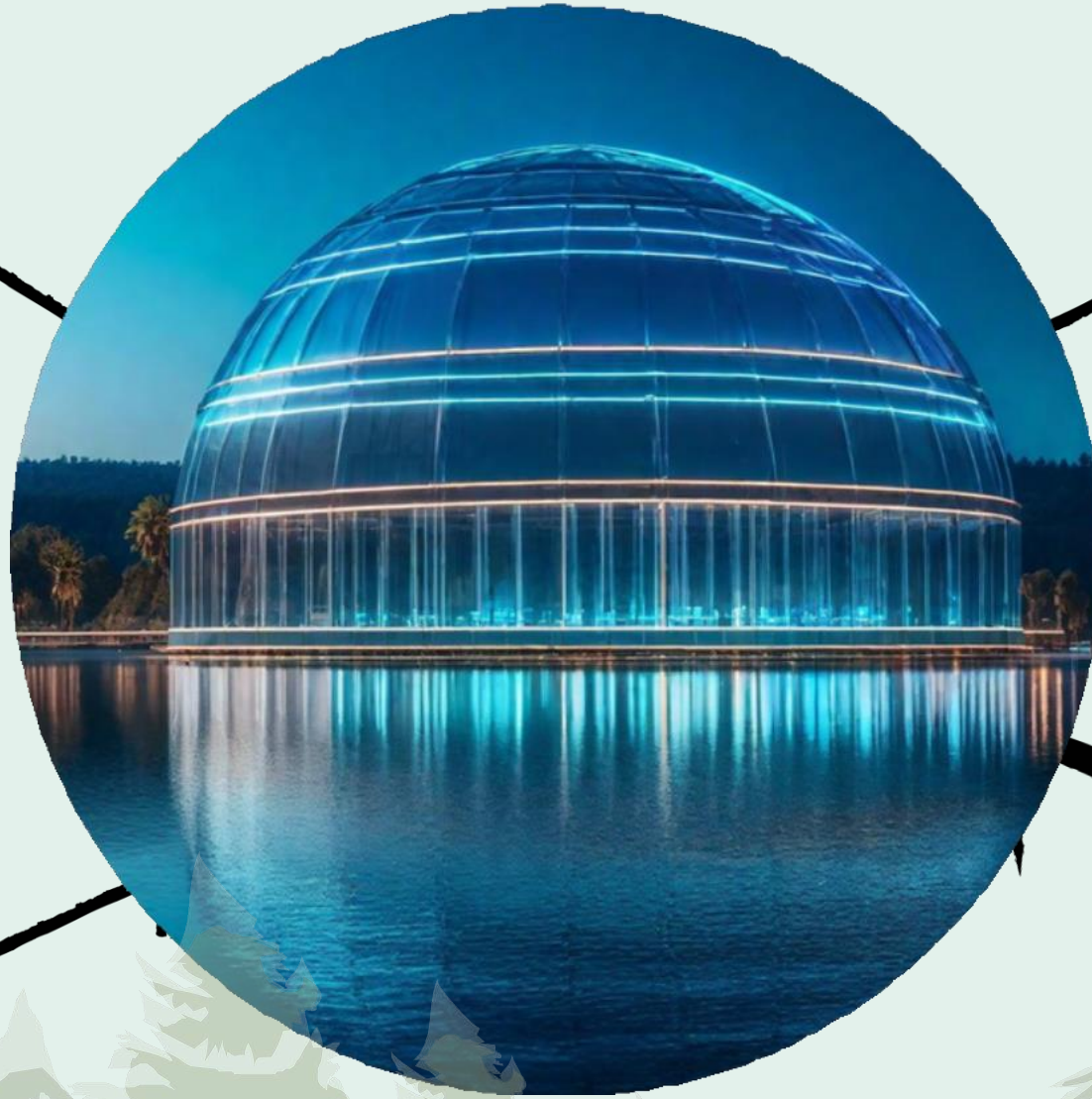

Conclusion

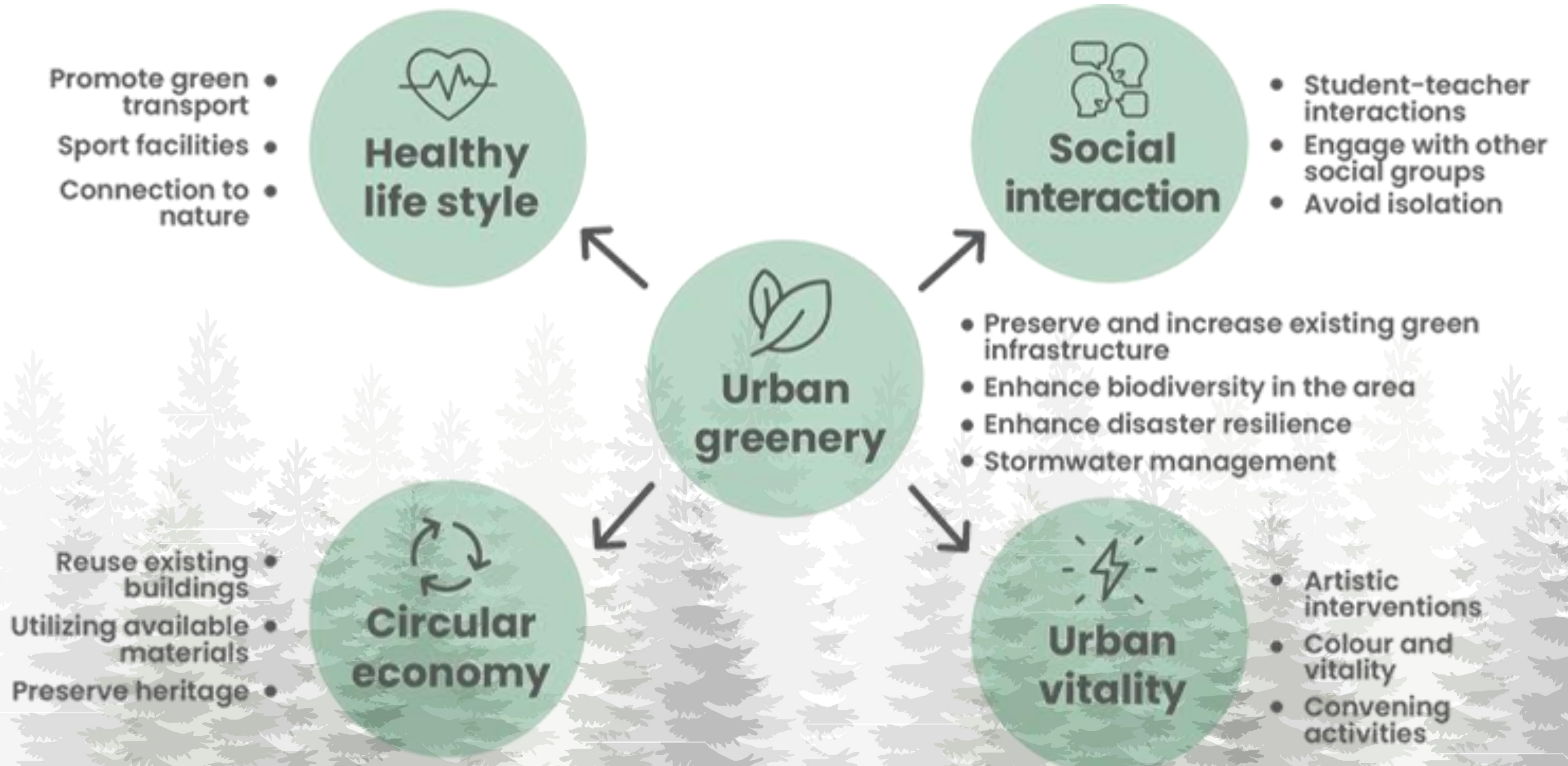

YOU DO NOT NEED TO GO TO A SUMMER COTTAGE WHEN YOU LIVE IN LAHTI

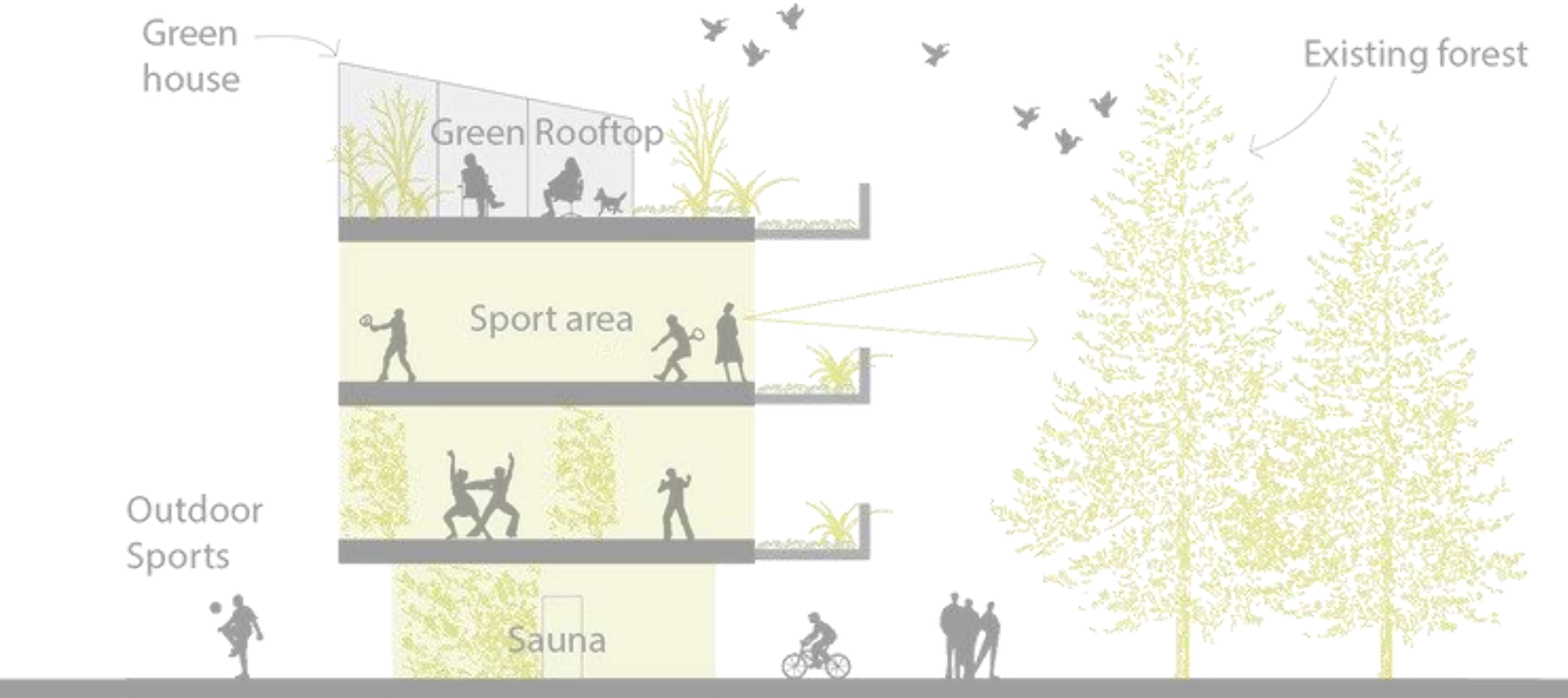

References:

- Hovi, A. & Raikas, H. Botany and Environmental Sciences specialists. Interview.
- Salminen, T. Uponor Clinic meeting 8.11.2023.
- United Nations. The 17 Goals. Cited 8.11.2023. Available at: <https://sdgs.un.org/goals>.
- Images: AI
- Link to Canva: <https://www.canva.com/design/DAFzINo6ZIk/ConHNFRFisanLjR-pTTchQ/edit>